



www.wct.ind.br



# MANUAL DO USUÁRIO

## BICICLETA ERGOMÉTRICA MAGNÉTICA DE EXERCÍCIOS

### REF. No. 44158



# MONTAGEM

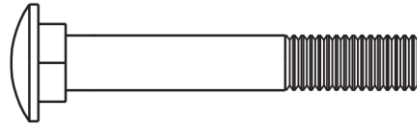
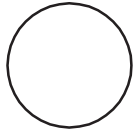
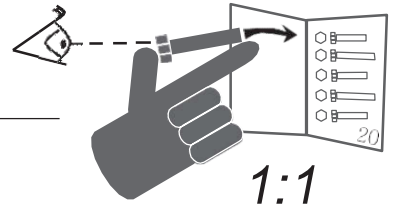
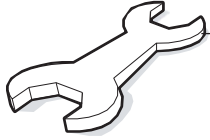

No.4  
Qdd4

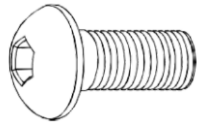

No.13  
Qdd4

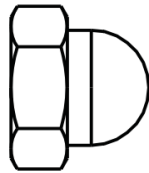
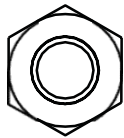

No.5  
Qdd4

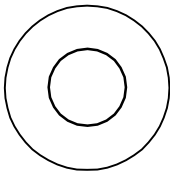

No.27  
Qdd1

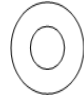

No.31  
Qdd 1

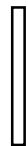
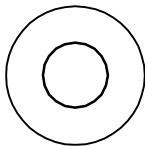

No.6  
Qdd4

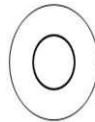

Qdd 4

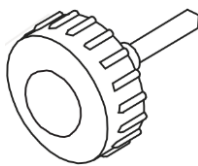

No.22  
Qdd 1

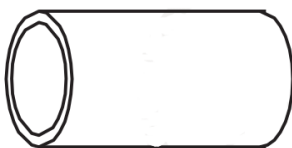
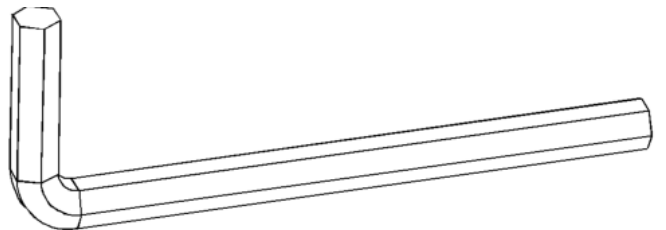

No.10  
Qdd1

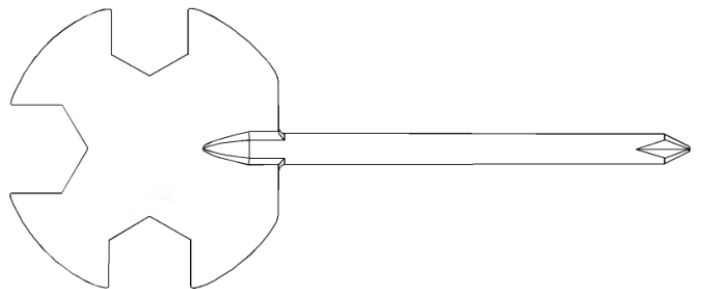

# MONTAGEM

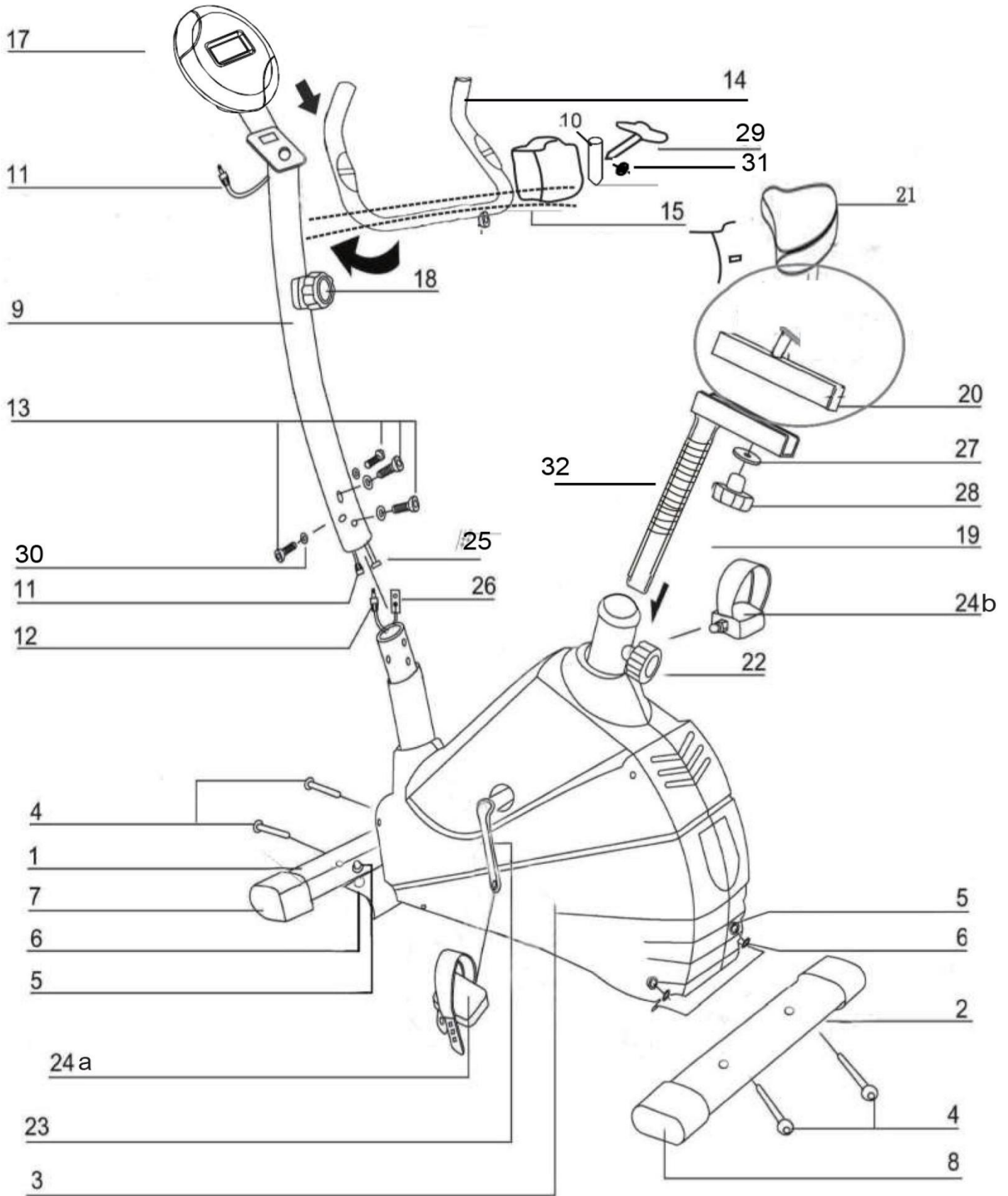



# MONTAGEM

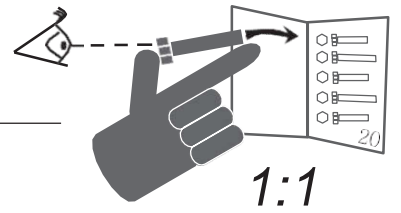

# 1

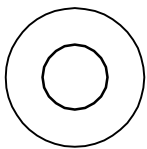
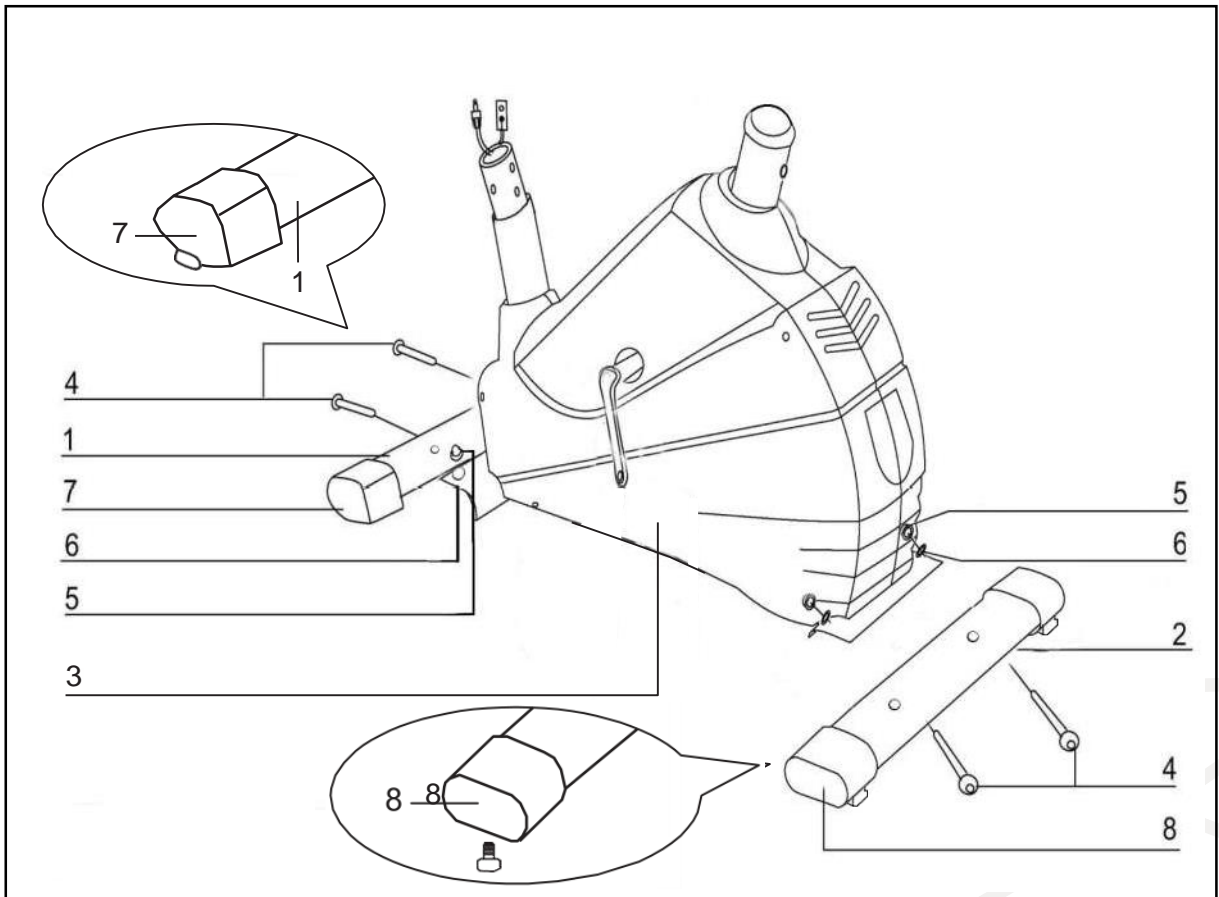

No.6  
Qdd4

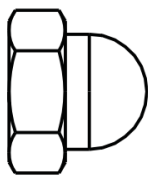
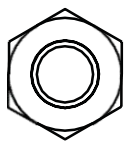

No.5  
Qdd4

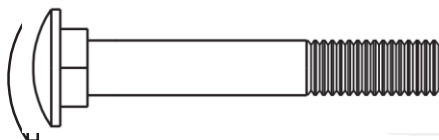
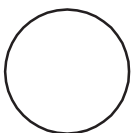

No.4  
Qdd4

# MONTAGEM

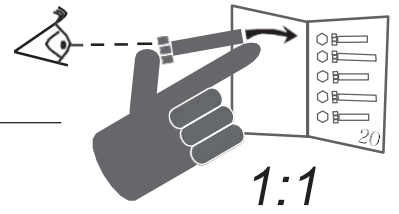
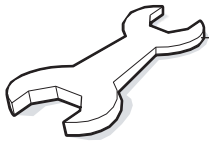

## 2

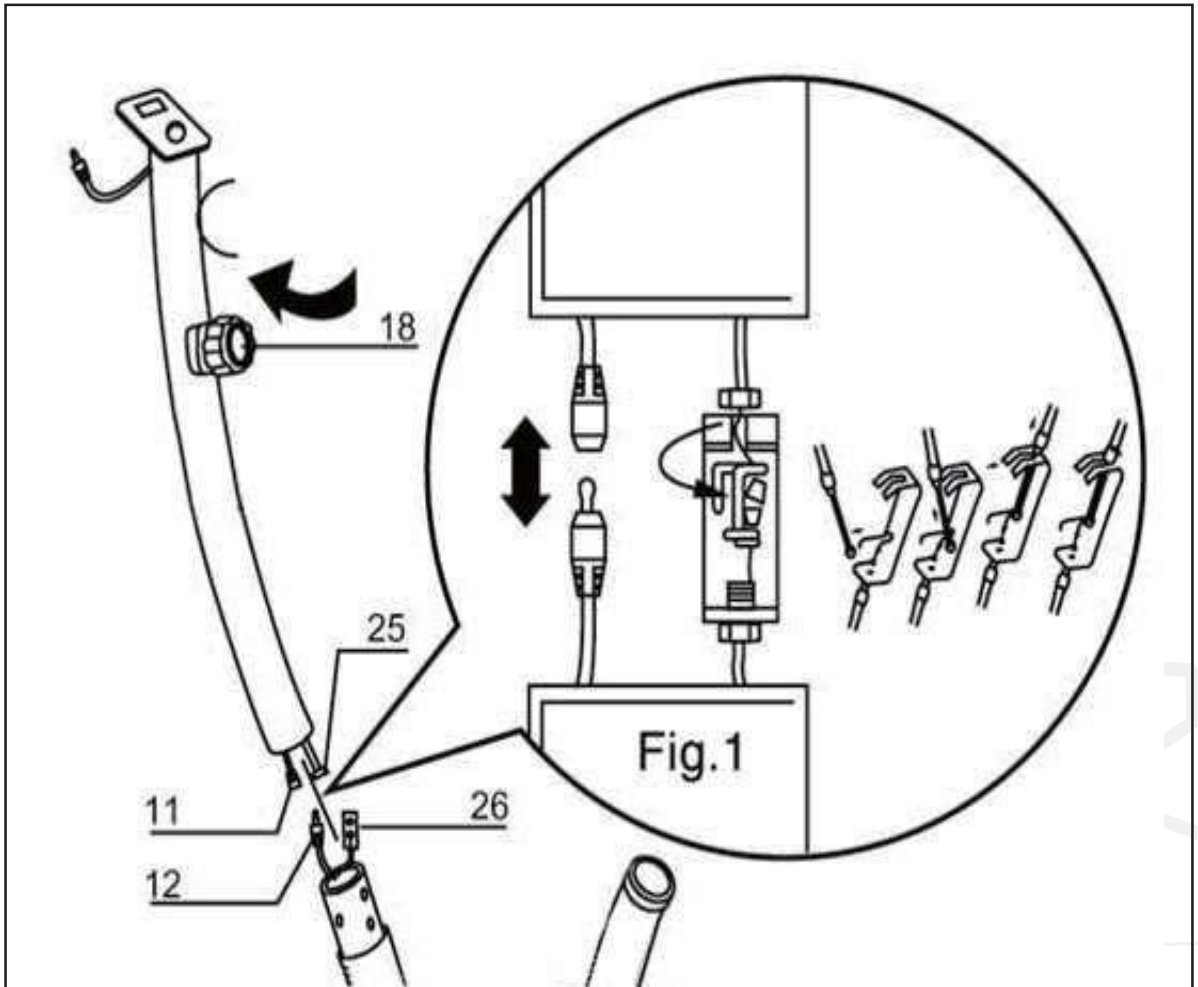

# MONTAGEM

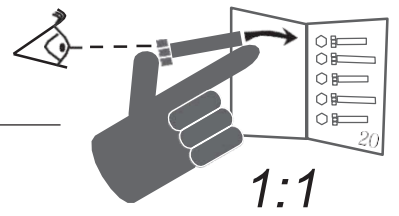
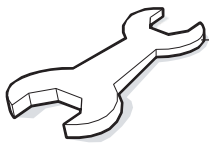

## 3

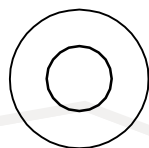
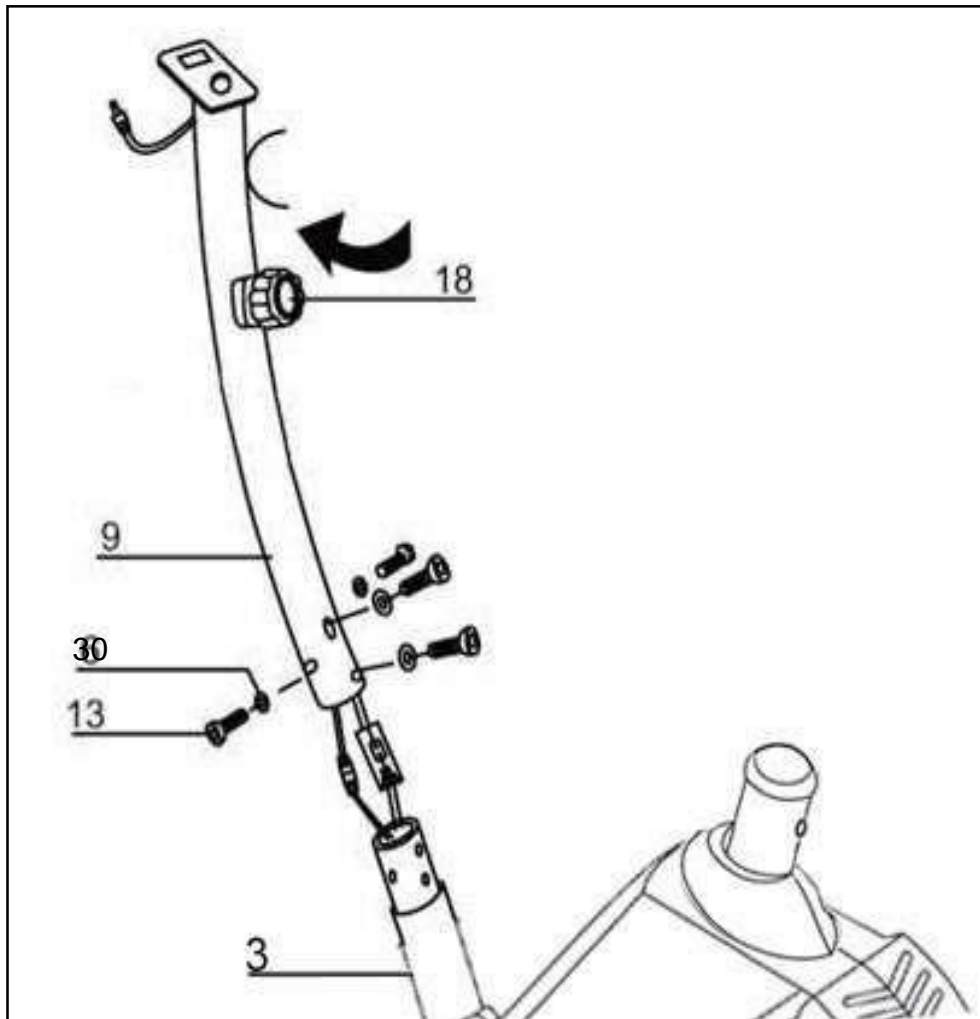

No.30  
Qdd 4

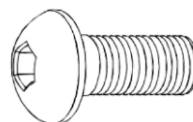

No.13  
Qdd4

# MONTAGEM

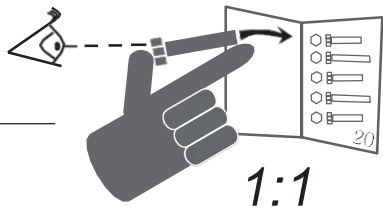
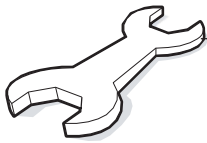

## 4

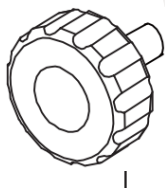
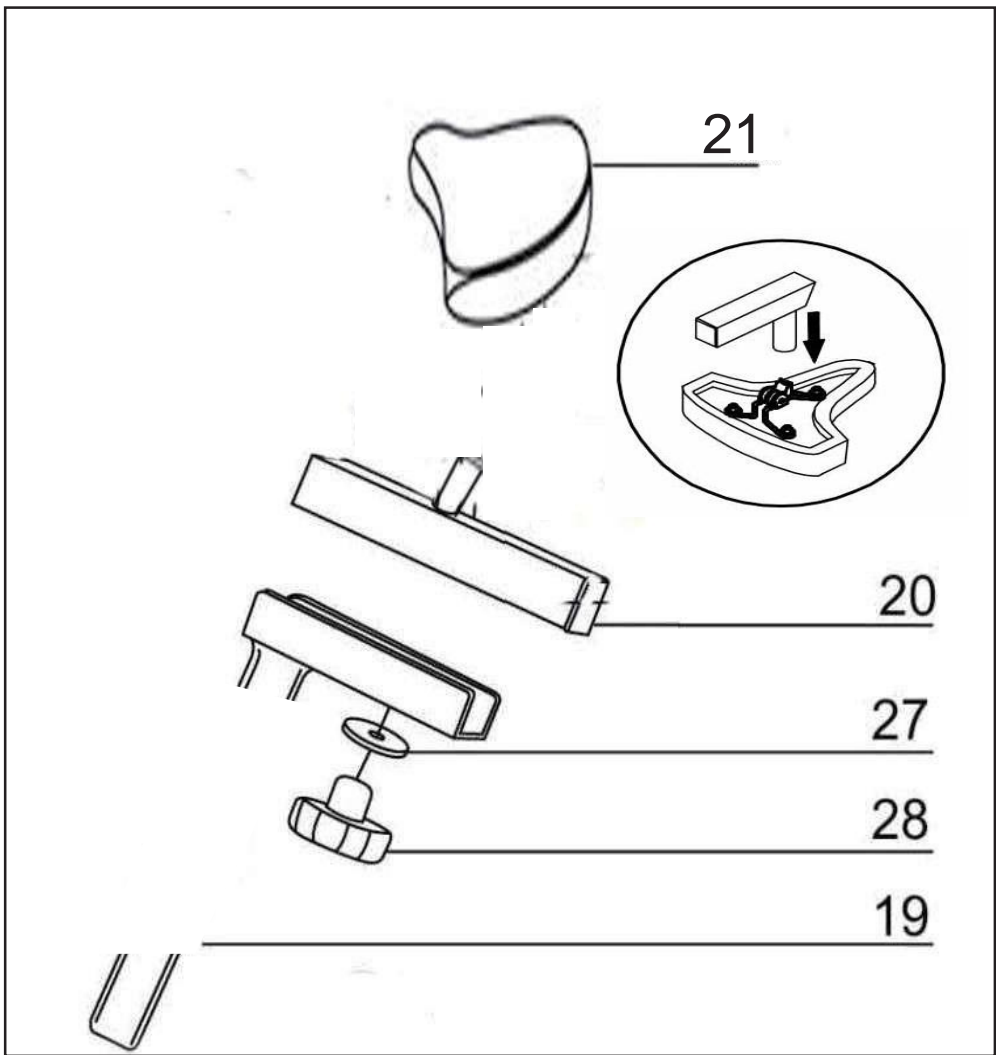

No.28  
Qdd1

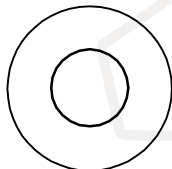

No.27  
Qdd1

# MONTAGEM

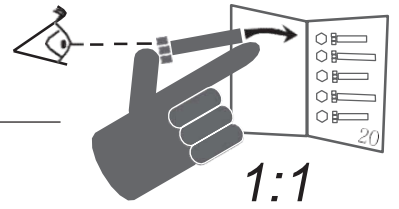
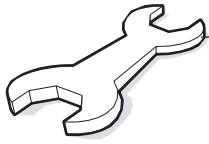

## 5

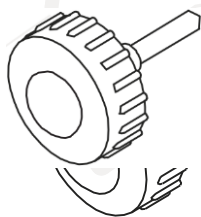
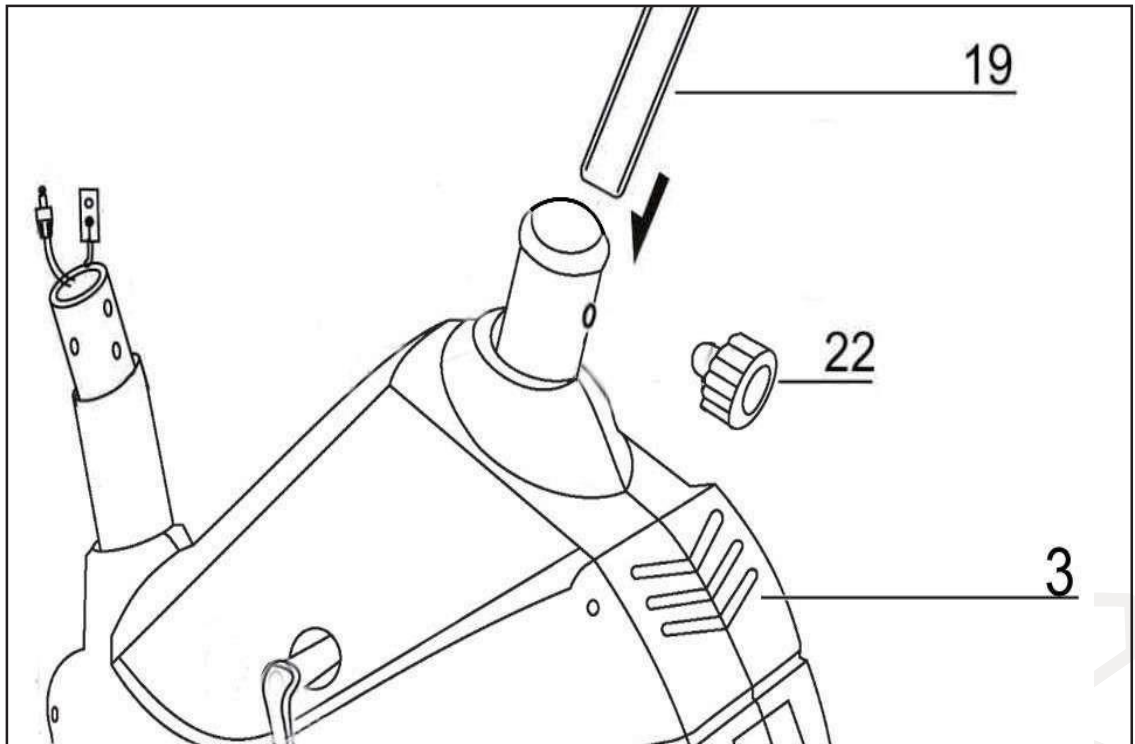

NO.22  
Qty1



# MONTAGEM

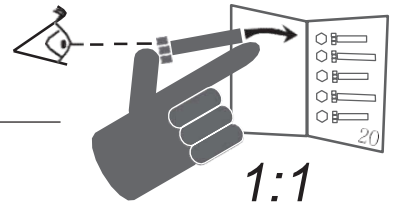
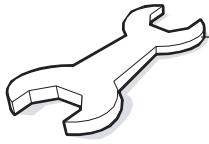

## 6

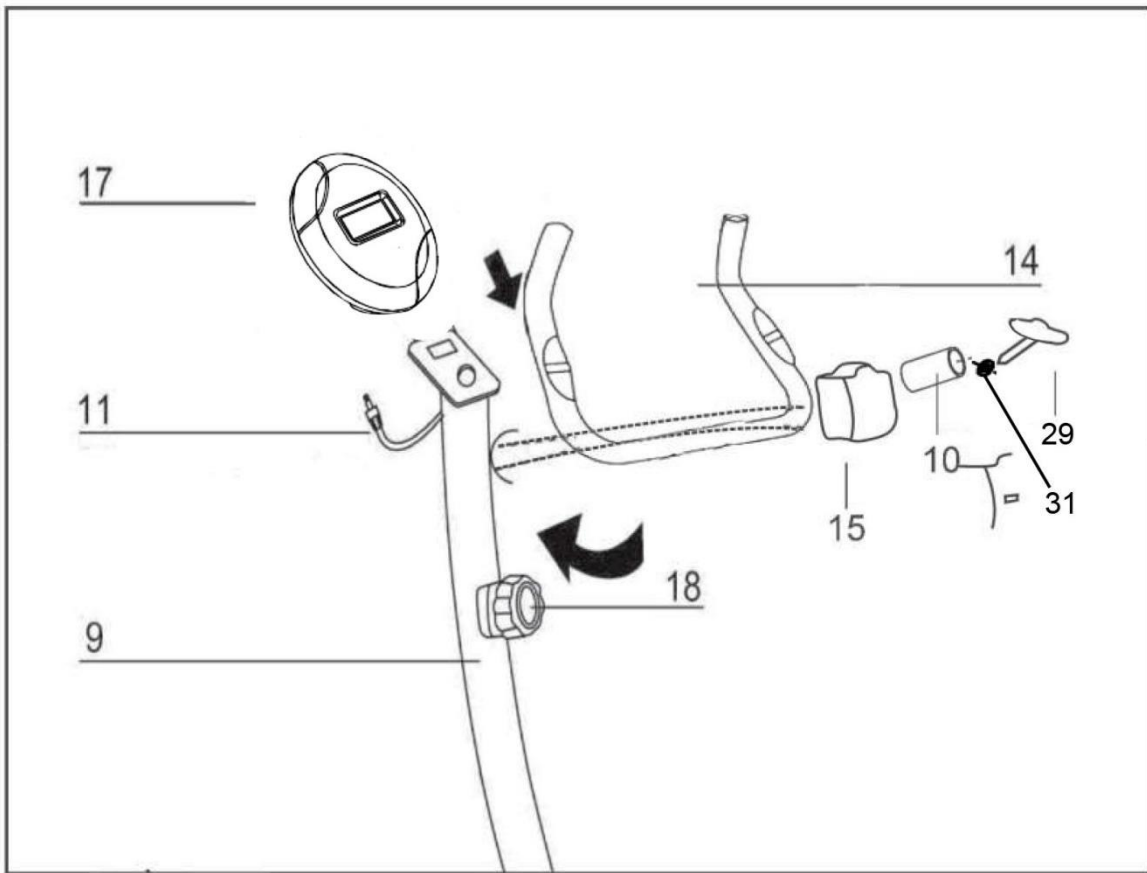

# MONTAGEM

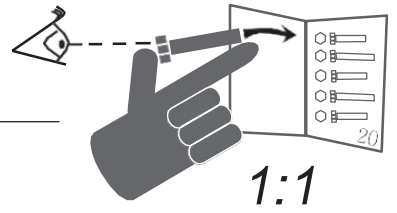
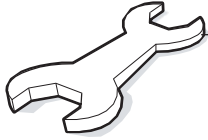

## 7

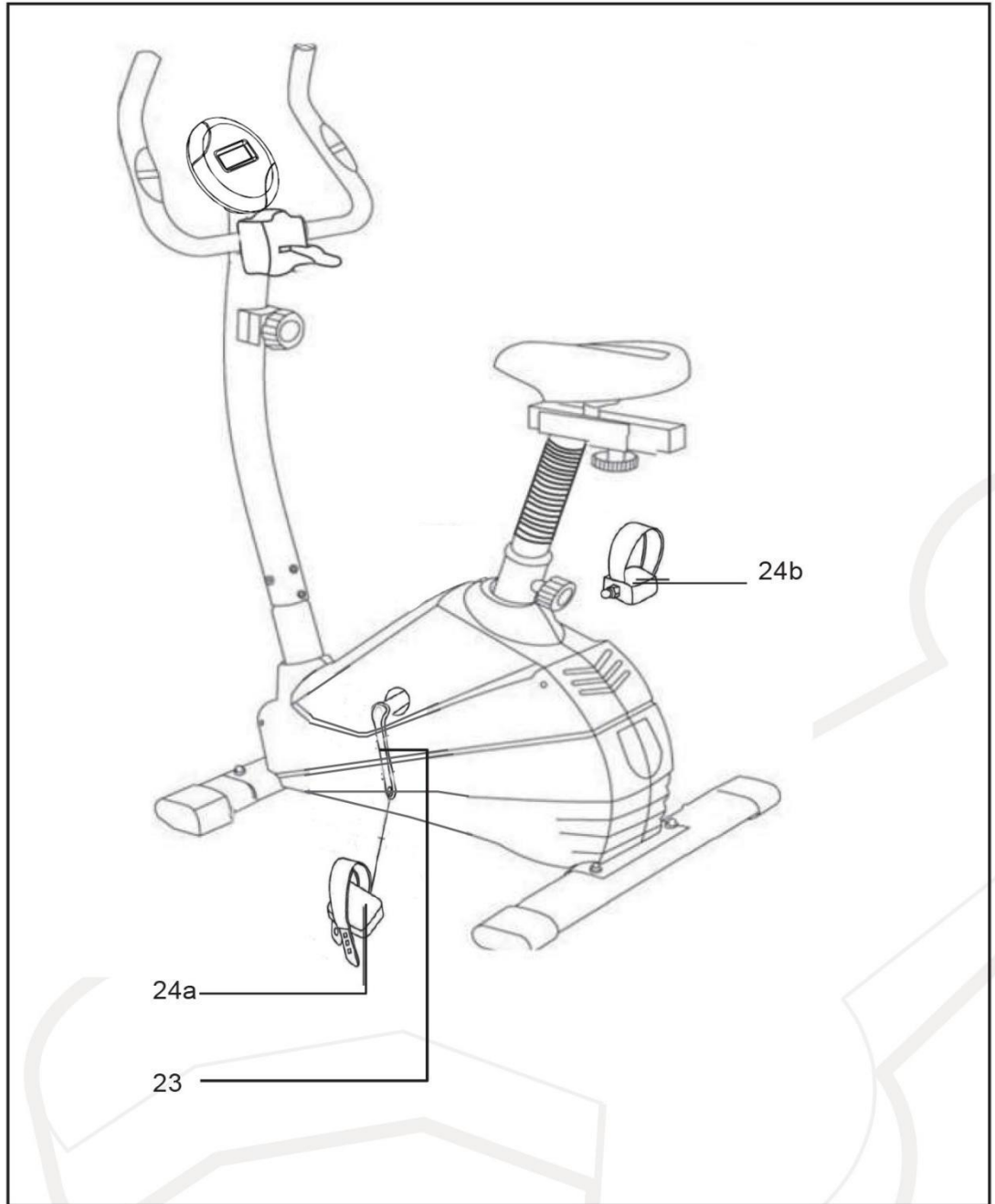

# MONTAGEM

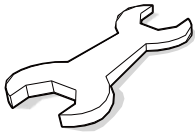

## NOMENCLATURA

No.	Descrição	Qdd
1	Estabilizador dianteiro .....	1
2	Estabilizador trazeiro .....	1
3	Quadro principal .....	1
4	Parafuso principal (M8 x 50mm L) ...	4
5	Porca em cúpula .....	4
6	Arruela (A) .....	4
7	Tampa frontal .....	2
8	Tampa trazeira .....	2
9	Barra frontal.....	1
10	Bucha botão da barra manipulador	1
11	Fio superior do sensor .....	1
12	Fio inferior do sensor.....	1
13	Parafuso cab.Allen (M8 x 15mm L) .	4
14	Guiador .....	1
15	Proteção plástica abaixo computador ..	1
16	N/A	
17	Computador.....	1
18	Tecla de tensão .....	1
19	Poste do assento .....	1
20	Ajuste.....	1
21	Assento .....	1
22	Botão de ajuste.....	1
23	Manivela(E/D) .....	2
24a	Pedal (Esquerdo) .....	1
24b	Pedal (Direito).....	1
25	Cabo de tensão .....	1
26	Gancho de tensão .....	1
27	Arruela (C) .....	1
28	Tecla de ajustamento .....	1
29	Botão de ajuste do guidão .....	1
30	Arruela .....	4
31	Arruela .....	1
32	Tampa do assento.....	1

Dúvidas, reclamações ou sugestões, entre em contato com a nossa  
Central de Atendimento ao Consumidor

[sac@wct.ind.br](mailto:sac@wct.ind.br)

[sac@wct.com.br](mailto:sac@wct.com.br)

Obrigado por ter adquirido um excelente produto

